

Altos S300 Rail Kit Installation Guide

Revision 1.0
September 2001



Rail Kit Installation Instructions

Before an enclosure can be installed in an equipment rack, the rail kit must be fitted to the equipment rack. The following procedures describe how to fit the rail kit and install the enclosure.

Rail Kit Contents

The rail kit should contain the following components:

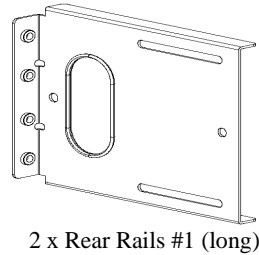
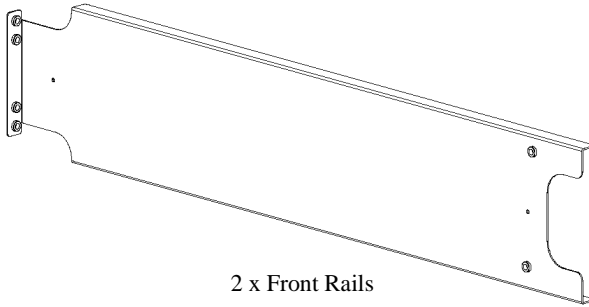

4 x Phillips SEMS Head Screw
10-32 x .31LG



8 x Phillips Flat Head Screws
10 - 32 x .50LG



8 x Conical Washer #10



2 x Phillips Truss Head Screws
10 - 32 x .75LG

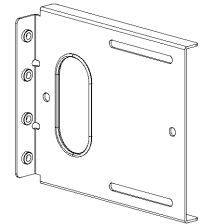

Once you have verified that all the components are present in the rail kit, you are ready to begin the installation.

Installing the Rail Kit

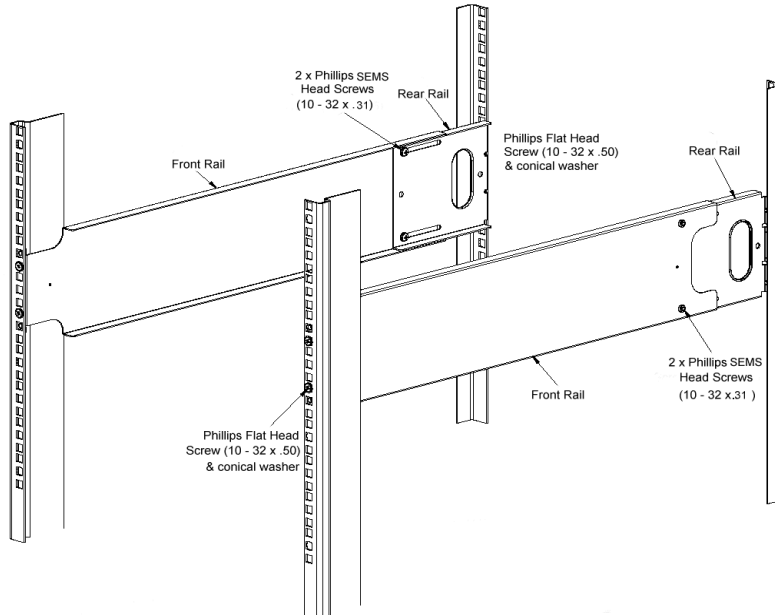

1. Select the location in the equipment rack where the enclosure is to be installed.
2. Depending on depth of the equipment rack, select rear rails #1 or #2.
3. Connect the front rails to the rear rails using the Phillips SEMS Head screws (10-32x.31), but do not tighten them as some horizontal adjustments may be required later.

4. Fix the front rails to the front posts of the equipment rack and secure in place using the Phillips Flat Head screws (10-32x.50) and the conical washer (washer to the outside of the post).
5. Adjust the rear rails to fit the depth of the equipment rack (using rear rails #1 or #2 as appropriate) by sliding them horizontally in or out. Fix them to the rear posts of the equipment rack using the Phillips Flat Head screws (10-32x.50) and conical washers (washer to the outside of the post).
6. Tighten the Phillips SEMS Head screws (10-32x.31) that fix the front and rear rails together (see Step 2).

The rail kit is now fitted and the enclosure can be installed in the equipment rack. The following section describes how to install the enclosure.

Installing the Enclosure

With the rail kit fitted the enclosure is installed in the equipment rack by following this procedure:

CAUTION: When installing or removing an equipment rack, remove all disk drives. It is recommended that you work with at least one other person. These precautions are necessary to prevent personal injury and damage to the enclosure.

1. Remove all disk drives from the enclosure.
2. Slide the enclosure into the equipment rack (rail kit).
3. Secure the enclosure in position using the two Phillips Truss Head screws (10-32 x .75 LG, Black) through the bottom two fixing holes on the front of the enclosure.
4. Install the disk drives in the enclosure.